

NEW FACULTY

Community Engagement Tour

EXPLORING NEW PLACES • **MEETING** NEW PEOPLE • **ENGAGING** NEW COMMUNITIES

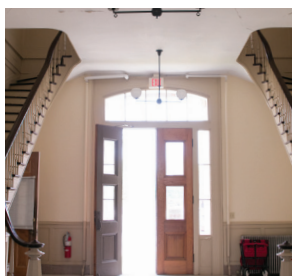



A MESSAGE FROM

Dr. Samory T. Pruitt

Vice President for Community Affairs

**Welcome to The University of Alabama's fourth
New Faculty Community Engagement Tour.**

The Division of Community Affairs is pleased that you have chosen to participate, and we believe this tour will be beneficial to you whether you are a faculty member, staff, a student or a community member.

The Division was created in 2004 and is recognized nationally and internationally for its leadership in community engagement. I am honored to be the immediate past president of the executive committee of the Engagement Scholarship Consortium, which coordinates activities and programs worldwide in this field.

Community-engaged scholarship exists at the intersection of teaching, research and service, the three pillars of The University of Alabama's mission. The tour plays an important role in advancing that mission by providing opportunities to connect, and for community members to become the teachers while members of the University community embrace the role of learner.

The tour — Exploring New Places, Meeting New People, Engaging New Communities — provides an exciting opportunity to see engagement scholarship in action. Its purpose is to encourage new community-University partnerships.

We are confident that this time together will prove to be a source of inspiration for each of you to connect your research passions to addressing community needs through new partnerships. You may also be encouraged by the work already taking place at various tour stops.

After the tour is complete and you have had an opportunity to explore new partnership possibilities, we invite you to share with us your plans, your progress and your victories.

All the Best,

A handwritten signature in black ink, appearing to read 'Dr. Samory T. Pruitt'. The signature is stylized and fluid, with a long horizontal stroke at the beginning and a large loop at the end.

Dr. Samory T. Pruitt

Vice President for Community Affairs



A MESSAGE FROM

Dr. James T. Dalton

Provost and Executive Vice President for Academic Affairs

The Division of Community Affairs, together with the Office of Academic Affairs, the Graduate School, the Center for Community-Based Partnerships and the Council on Community-Based Partnerships, conducted the first New Faculty Community Engagement Tour: Exploring New Places, Meeting New People, Engaging New Communities in 2017. The tour, which was designed to assist new faculty in learning about the University's partnership efforts in nearby communities, featured three, daylong explorations throughout West Alabama and the Black Belt region. It was a resounding success and, accordingly, we committed to offering it annually.

Modeled after tours sponsored by other Engagement Scholarship Consortium (ESC) member institutions, these three days in May provide unique insights into the possibilities

that exist through community-engaged scholarship. Our hope is that the knowledge gained through participation will assist faculty and staff, graduate students and community partners in identifying community needs that overlap with research interests and coursework, as well as facilitate innovative partnerships that connect community partner learning opportunities with University resources, enabling both to benefit from authentic and inventive community engagement.

We are pleased to continue the tour this year, following a two-year hiatus brought about by the COVID-19 pandemic. The pandemic cast a spotlight on the disparities and challenges faced by some populations and communities as opposed to others, further affirming our efforts. This year's tour includes stops in nine West Alabama counties — including Walker County for the first time.

UA's mission — to advance the intellectual and social condition of the people of the state, the nation and the world through the creation, translation and dissemination of knowledge, with an emphasis on quality programs in the areas of teaching, research and service — undergirds our community-engaged scholarship endeavors. These efforts provide a unique opportunity to combine teaching, research and service in ways that aid the communities we are privileged to serve.

Thank you,

A handwritten signature in black ink, appearing to read 'J. Dalton', written in a cursive style.

Dr. James T. Dalton

Provost and Executive Vice President for Academic Affairs



JASPER WALKER COUNTY

Day 1 // Stop No. 1

Walker Area Community Foundation

Founded 25 years ago, the Walker Area Community Foundation is a nonprofit, grantmaking organization. Its mission is to build a permanent endowment that will forever help support the charitable needs of the community and improve the quality of life for the people of Walker County and the surrounding area. Since its inception, the Foundation has grown from \$6 million to \$81 million, while giving away \$26 million to more than 490 nonprofit organizations across the state. The Foundation supports quality of life through funding initiatives involving the arts and humanities, education, recreation, eldercare, health and social welfare.

Walker County Health Action Partnership

Since 2014, the Walker County Health Action Partnership has collaborated with community organizations, neighborhoods and local residents to support increased health outcomes for Walker County. Its anchor organizations are the Walker Area Community Foundation, United Way of Central Alabama, Capstone Rural Health Center and Brookwood Baptist Health System. The Partnership is founded on community-based collaborations and has leveraged more than \$1.6 million in local, state and federal funding to improve health outcomes.



SITE COORDINATOR PAUL KENNEDY

Paul Kennedy
President, Walker Area Community Foundation

Cristy Moody
Executive Vice President, Walker Area Community Foundation

FIRST UNITED METHODIST CHURCH

Rachel Puckett
Deputy Director, Capstone Rural Health Clinic

Mary Slaughter
Director of Assessment and Accountability, Guidance Counseling, Title IV, & Community Education, Walker County Schools



CARROLLTON PICKENS COUNTY

Day 1 // Stop No. 2

Aliceville Museum

The Aliceville Museum was begun in the 1980s as an exhibit in a single room at the Aliceville Public Library. In 1993, a donation of the former Aliceville Coca-Cola Bottling Plant buildings and property set the stage for future Museum growth. Today it boasts four exhibits, including one that features artifacts from the Aliceville Prisoner of War Camp, which existed from 1942 to 1945. It includes the largest collection of WWII POW artifacts in the U.S. The Museum also features the complete and intact bottling equipment of the Aliceville Coca-Cola Bottling plant in a Coca-Cola exhibit. Local history items are shown on display in the Aliceville and Pickens County Exhibit, including photographs from one of Alabama's first female commercial photographers, Willie Gardner.

Growth and Progress in Aliceville

In 2014, ALProHealth and Alabama Cooperative Extension System were given a grant from the CDC to address obesity in Alabama. Pickens County was designated a candidate, and Aliceville was chosen as the recipient. Today it is the home of a bi-weekly farmers market hosted from May to September. Aliceville is also the home of many new businesses. Growth in commerce, industry and agriculture is a key component of the initiative to foster a healthy and thriving city in Pickens County.

SITE COORDINATOR TEIRDRE OWENS

Lakitha Bell

Director, Emergency Management Agency and E 911

Jerry Finch

County Commissioner, District 4

CARROLLTON SERVICE CENTER

Todd Hall

Sheriff, Pickens County

Bobby Ingram

County Commissioner, District 2

Pickens County Board of Education





NORTHPORT TUSCALOOSA COUNTY

Day 1 // Stop No. 3

Capstone Hospitalist Group

Established by University Medical Center in partnership with DCH Health System in Tuscaloosa, the Capstone Hospitalist Group is a group of physicians and nurse practitioners who care for hospitalized patients in DCH Regional Medical Center in Tuscaloosa and Northport Medical Center in Northport. Services include in-patient care after emergency room visits or doctor referrals, continuity of care with patients' primary-care physicians and patient consultation.

a National Endowment for the Arts and Alabama State Council on the Arts sponsored initiative that delivers monthly art kits to children ages 4-12 in public housing communities. The festival features over 270 artists, live music, activities for children, folk and contemporary craft demonstrations.

Robert Hason Community Center

Through his nonprofit, Academics in Motion, Northport City Councilman Woodrow Washington purchased the Robert Hason Community Center from the city of Northport in 2018 to keep the facility a go-to place for families. Named after Northport's first African American councilman, the center offers after-school tutoring, learning through sports, computer literacy, senior citizen outreach programs and community partnerships.

Kentuck Art Center and Festival

The Kentuck Art Center and Festival engages community members and artists in Northport. The Center supports art education through year-round programming and outreach, such as "Boxes of Joy,"



SITE COORDINATOR GLENDA WEBB

NORTHPORT CIVIC CENTER

Brad Matthews
Senior Engineer, City of Northport

Brooke Starnes
Public Works Director, City of Northport

Darren McGee
Finance Director, City of Northport

Glenda Webb
City Administrator, City of Northport

Julie Ramm
Director of Planning and Inspections, City of Northport

John Powell Webb
Utilities Director, City of Northport





EJTAW GREENE COUNTY Day 2 // Stop No. 1

Housing Authority of Greene County and UA HomeFirst Program

Since 2019, Anita Lewis, executive director of the Housing Authority of Greene County, Alabama, has been a committed community partner to the UA HomeFirst program. The Housing Authority of Greene County gives residents an opportunity to buy the unit they are currently renting; however, it does not have a homebuyer education program. In 2021, Lewis partnered with the UA HomeFirst program to apply for the U.S. Department of Agriculture’s Rural Community Development Initiative grant program, which provides funding to help nonprofit housing and community development organizations, low-income rural communities and federally recognized tribes support housing,

community facilities and community and economic development projects in rural areas. The grant was successful, and over the next three years The University of Alabama will provide financial and technical assistance to improve the Housing Authority of Greene County’s capacity to deliver homebuyer and financial education.

Greene County Hospital

The Greene County Hospital is the hub for the Greene County Health System, which includes the hospital, the Greene County Physicians Clinic and the Greene County Residential Care Center. Its mission is to provide optimal medical care to the residents of Greene and surrounding counties.

SITE COORDINATOR JUDGE LILLIE JONES-OSBORNE

ROBERT H. YOUNG COMMUNITY CENTER

Michael Barton
SEED ELITE

Corey Jones
Superintendent, Greene County School System

Lillie Jones-Osborne
*District Judge, Greene County
Chairman, Greene County Children’s Policy Council*

Jazmin Mitchell
SEED ELITE

Mildred Morgan
*Coordinator, Greene County Community in Action Coalition
Facilitator, Strengthening Family Program*

Marcia Pugh
CEO, Greene County Health System

Carol Zippert
The Society of Folk Arts and Culture





YORK SUMTER COUNTY
Day 2 // Stop No. 2

Hill Hospital

Hill Hospital of Sumter County provides general medical and surgical care, as well as emergency room care, to the citizens of Sumter County through both the hospital and its many clinics. Over the years, Hill Hospital has engaged in a number of partnerships with UA.

Coleman Center for the Arts

The Coleman Center for the Arts was founded in 1985 through the grassroots efforts of the citizens of Sumter County to promote positive social change, address civic needs, build local pride and use creativity for community problem-solving. It achieves these goals through programs such as an artist-in-residence, an annual exhibition of local art and an education program. The Center is supported through local, state and national donations.

Board of Education

The Sumter County School System consists of three middle schools and one high school. The school system has long struggled from a low tax base that results in tight budgets for the schools. The University of Alabama has been part of the UA/UWA In-Service Center and AMSTI for many years, and Sumter Central High School is a GEARUP participant.

SITE COORDINATOR MARCUS CAMPBELL

POPSTART COMMUNITY SPACE

Tommie Armistead
County Commissioner, District 4

Wendell Larkin
*Former School Board Member
Local Business Owner*

Jeffrey Artis
Local Business Owner

Audra Tignor
Operations Director, Coleman Center for the Arts

Willie Lake
Mayor, City of York

Loretta Wilson
Administrator, Hill Hospital of Sumter County





GREENSBORO HALE COUNTY

Day 2 // Stop No. 3

Salem Missionary Baptist Church

Founded in 1869, Salem Missionary Baptist Church traces the roots of its founders to the original Salem Baptist Church in Old Troy (on the eastern edge of what became Greensboro, Alabama). With \$2,000 from the proceeds of the sale of the original Salem Baptist Church, former slaves built their own church on Baptist Hill, which is the present-day location of Salem Missionary Baptist Church. Salem has at various points doubled as a school in addition to being a house of worship. Its founders were motivated by a widely shared impulse to possess their own church, which was common among emancipated slaves. Salem stands as a symbol to its founders' drive for self-ownership, religious independence, and civic engagement that came after emancipation, and continues today.

SITE COORDINATOR LLEVELYN RHONE

Emily Guo
Community Health Fellow, Horseshoe Farm

Ellie Hough
Community Health Fellow, Horseshoe Farm

Jovita Lewis
Hale County Coordinator, Cooperative Extension

Safe House Museum

The Rev. Martin Luther King, Jr. sought safety from the Ku Klux Klan in 1968 in a modest house in Greensboro two weeks prior to his assassination. An active Civil Rights Movement participant and friend of the King family converted the house into the Safe House Black History Museum to document the local area's participation in the struggle.

PROJECT HORSESHOE FARM

Emily McGlohn
Associate Director, Rural Studio, Auburn University

Michael Ryans
Superintendent, Hale County Board of Education





NEWBERN PERRY COUNTY

Day 3 // Stop No. 1



C.H.O.I.C.E.

Founded in 2009 by Emefa Butler, the nonprofit C.H.O.I.C.E. (Choosing to Help Others in our Community Excel) has as its mission the creation of collaborative partnerships to ensure that community members have access to charitable and educational resources. Located in Uniontown, the CHOICE Resource Center serves as the community hub for charitable and educational resources. The organization provides programs and services including workforce development, mentoring, education, cultural arts, health and wellness and athletics and recreation.

Rural Studio

The Rural Studio is a design-build program of Auburn University. Established in 1993, the

program gives architecture students a hands-on educational experience while assisting underserved populations in West Alabama's Black Belt region. To date, Rural Studio has built more than 200 projects and educated more than 1,200 students in the Black Belt.

R.C. Hatch High School

The mission of R.C. Hatch High School is to ensure that all students are college- and career-ready by seeking to create a challenging learning environment that encourages high expectations for success through development-appropriate instruction that allows for individual differences and learning styles. The school promotes a safe, orderly, caring and supportive environment.



SITE COORDINATORS EMEFA BUTLER & HOLLY LUTHER WEST PERRY VOLUNTEER FIRE DEPARTMENT

Donald Bennett
Board President, Main Street Marion

Frances Ford
Executive Director, Sowing Seeds of Hope

Sandra Fowler
Principal, Marion Academy

Emily Kynard
Executive Director, Berean Baptist Headstart

Michael Luther
Physician, Cahaba Medical Care-Marion

Darren Ramalho
Head of School, Breakthrough Charter School

Geneva Robinson
Executive Director, Uniontown Housing Authority

Marcia Smiley
Superintendent, Perry County Board of Education

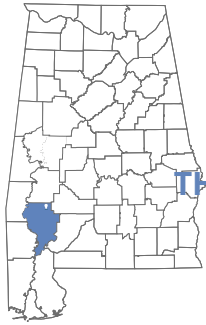

THOMASVILLE CLARKE COUNTY

Day 3 // Stop No. 2

Thomasville Public Library and Career Readiness Center

The Thomasville Public Library and Career Readiness Center is in the process of transitioning to the renovated and expanded Bedsole Building in Downtown Thomasville. The Library offers story hour for ages 3–7 and a monthly book club for ages 8–14, as well as adult technology learning classes. To support career readiness, the Library also offers a Workforce Development and Career Readiness Service. The initiative offers a small business development toolkit, résumé help, assistance with job searches and online applications, as well as refreshers and instruction in keyboarding, Microsoft Office and interview preparation.

Westervelt

In 2020, Westervelt completed a \$190 million project in Thomasville, a new lumber mill, which shipped out its first load of lumber in March 2021. Westervelt was founded in 1884 in Tuscaloosa and is currently under the fourth generation of family leadership. The Thomasville lumber mill is the company's second lumber mill and employs 170 people. Westervelt is an industry leader in land management, wood products manufacturing and environmental mitigation. The company is recognized for excellence in sustainable forest management, responsibly sourced forest products and services, natural resource stewardship and ecosystem conservation.

SITE COORDINATOR AMY PRESCOTT

Vicki Morris
Principal, Thomasville Elementary School

Rosalyn Sales
Executive Director, Economic Development Clarke/Washington Counties

THOMASVILLE CIVIC CENTER

Nichole Stinson
Director, Thomasville Public Library

Roy Waite
Director, Clarke County EMA/Thomasville City Council

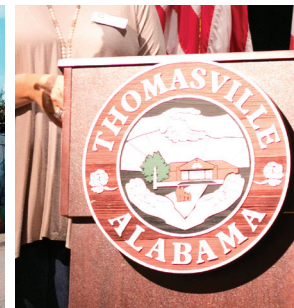



SELMA DALLAS COUNTY
Day 3 // Stop No. 3



Black Belt Community Foundation

The Black Belt Community Foundation (BBCF) mission is the focal point for gifts and grants to have an impact on those living and working in the region. It was founded in 2004 and has put critical resources into the region to make a lasting impact. Through “Giving,” “Receiving,” and “Growing,” the BBCF focuses on consolidating many region-wide improvement efforts into a common endeavor with a simple mission: “taking what we have to make what we need.” These three areas also move the region forward in attaining a vision of a transformed Black Belt where all residents contribute to healthy communities and reap the benefits of shared gifts and a productive regional economy.

Edmund Pettus Bridge

Unfortunately, the Edmund Pettus Bridge is most famous for one of the most terrible events of Alabama’s history — the Bloody Sunday event where African Americans seeking the right to vote were attacked while marching across the bridge on their way to Montgomery. In the African American community, the bridge has come to symbolize their nonviolent struggle and bravery in the face of overwhelming odds. It is ironic that the bridge is named after a Confederate brigadier general and Ku Klux Klan leader. The reporting of the events of Bloody Sunday and other similar happenings influenced the passing of the Voting Rights Act of 1965 later that year.



SITE COORDINATOR SHERYL SMEDLEY

SELMA AND DALLAS COUNTY PUBLIC LIBRARY

Lydia Chatmon
Prevention Director, Selma AIR, Inc.

Kathy Thomas
Education Coordinator, Head Start

Daron Harris
Public Relations Director, Black Belt Community Foundation

Becky Youngblood
Executive Director, Arts Revive

Keshee Dozier Smith
CEO, Rural Health Medical Program, Inc.



Council on Community-Based Partnerships

THE UNIVERSITY OF
ALABAMA[®] | Division of
Community Affairs
Center for Community-Based Partnerships

 UACommunityAffairs
UA.CCBP

 UACommAffairs

 ua_community_affairs

 communityaffairs.ua.edu

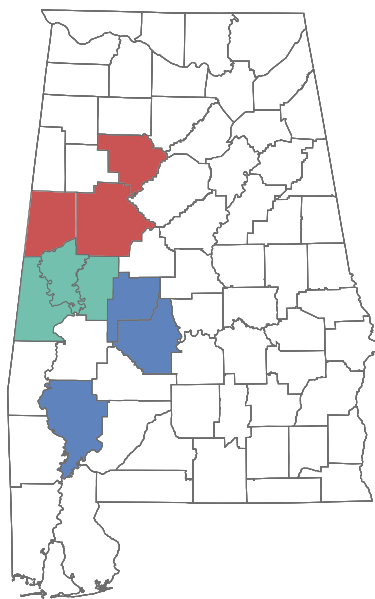

 **DAY 1**

WALKER COUNTY

PICKENS COUNTY

TUSCALOOSA COUNTY



 **DAY 2**

GREENE COUNTY

SUMTER COUNTY

HALE COUNTY



 **DAY 3**

PERRY COUNTY

CLARKE COUNTY

DALLAS COUNTY

THE UNIVERSITY OF
ALABAMA

Division of
Community Affairs
Center for Community-Based Partnerships

